

## GUELL 3 A/W



<b>Part number</b>	06171094
<b>Lampholder:</b>	LED
<b>Light Source:</b>	LED
<b>Wattage:</b>	317 W
<b>Finish:</b>	GR-94 / Metallic grey / Textured
<b>Insulation class:</b>	I
<b>Degree of protection:</b>	IP66
<b>IK-J-xxIP:</b>	IK07 3J xx5
<b>CRI:</b>	80
<b>Kelvin:</b>	4000
<b>Power factor:</b>	COSφ ≥ 0,9
<b>Optic:</b>	Asymmetric Wide Reflector
<b>Lightsource lumen output:</b>	44312 lm
<b>Luminaire lumen output:</b>	33867 lm
<b>L:</b>	L70
<b>B:</b>	B10
<b>Lifetime:</b>	130000 h
<b>Ta MIN luminaire:</b>	-30°
<b>Ta MAX luminaire:</b>	35°



### Description

- LED floodlight for indoor and outdoor lighting, comprising:
- Die-cast aluminium housing chemically pre-treated and painted with polyester powder coating
  - Flat extra clear tempered glass diffuser
  - Very high performance asymmetrical reflector made of 99.99% plated aluminium, polished, oxidised and free of iridescence
  - Anti-aging silicone gasket
  - Cable gland M20x1.5 for cables Ø 10- Ø 14 mm
  - Stainless steel external screws
  - Fully integrated stainless steel aluminium spring clips
  - Powder coated steel bracket
  - Dimmable ballast on request
  - 3000 K and 5000 K available upon request
  - Photometric data measure according to UNI EN 13032-4 and IES LM-79-08

### Photometric data

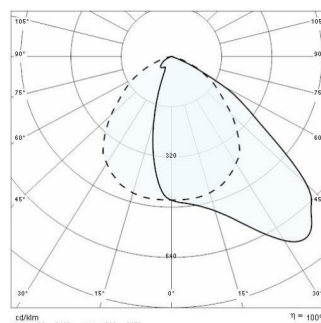

### Technical drawings

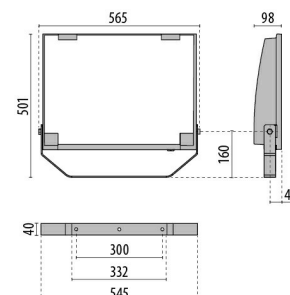

## OPTIONAL ACCESSORIES

### GUELL 3 A/W - S/W

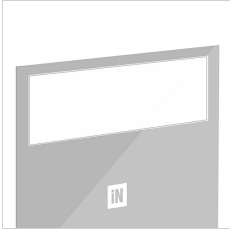

14452994  
Frosted glass GUELL 3

### GUELL 3 A/W

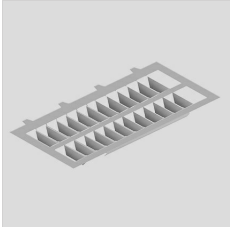

14454520  
Louvre GUELL 3 Asymmetrical A40/W



14452894  
Cover A40/W

### GUELL 3

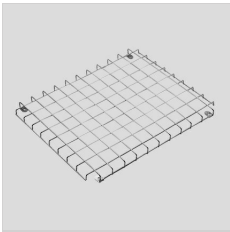

14452702  
Protective grid



14453994  
Wall mount support 1000 mm

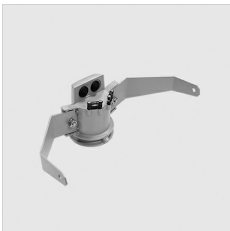

14453794  
Single pole top support GUELL 3 for poles Ø 60-76 mm/Ø 2.36"-2.99"



14453894  
Double pole top support GUELL 3 for poles Ø 60-76 mm/Ø 2.36"-2.99"

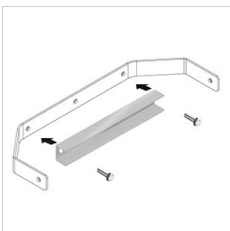

14461104  
GUELL 3 strengthening bracket.  
Suitable for one floodlight single  
point fixing M10 screw in centre of the  
bracket